



JENDOCO REAL ESTATE

TRY OUR
NEW WEBVISION

jendoco-re.com

Beatty Road Business Park 616-C Beatty Road

2,838 Total Square Feet
1,195 Square Feet of Finished Office



MAIN FEATURES

- Clear Height: 17ft. Above finished floor to underside of structural steel
- Exterior: Insulated wall panel
- Glass wall system at offices

UTILITIES

- Electric: 120/208 volt, three phase four wire
- Natural Gas: Columbia Gas
- Water & Sewage: Monroeville.

MISCELLANEOUS

- Ample truck access and maneuvering
- 4 ft. high loading docks and overhead door at grade
- 24 hour, 7 day a week access



Contact Bob Lloyd - T 412-361-4509 F 412-361-4790 - Internet www.jendoco-re.com

All information furnished regarding properties for rent or sale are subject to errors, omissions, change of price or rental and change or withdraw without notice. Rental terms, all dimensions and specifications are approximate and subject to change without notice.

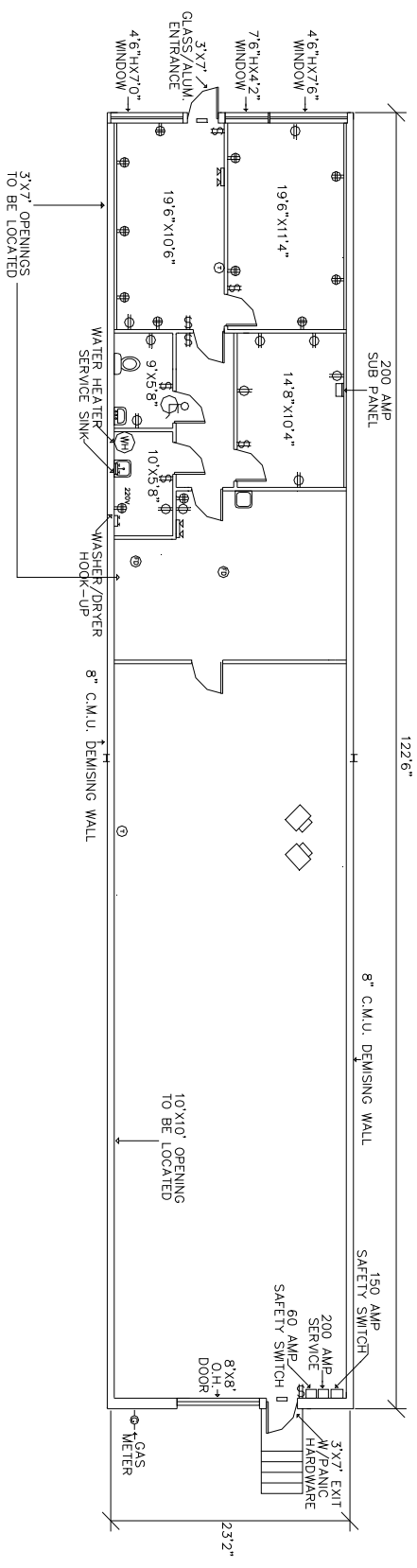

2,838 SQUARE FEET TOTAL AREA
 1195 SQUARE FEET FINISHED AS OFFICE

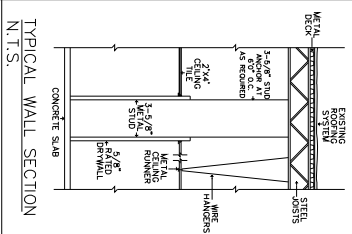

ALL INFORMATION ON THIS DRAWING MUST BE FIELD VERIFIED FOR ACCURACY. OWNER ASSUMES NO LIABILITY FOR INFORMATION UTILIZED FROM THIS DOCUMENT.

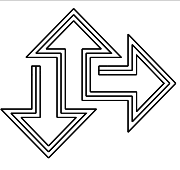

JENDOCO REAL ESTATE
CAD Design Team
 2000 Lincoln Road
 Pittsburgh, Pa 15235
 Phone: (412) 361 - 4509
 Fax: (412) 361 - 4790

BEATTY ROAD BUSINESS PARK		SCALE: 1/8"=1'	APPROVED BY: PB
		DATE: 12/1/09	DRAWN BY: PB
BR-616-C		PARKMNST ASSOC.	
		REVISED	

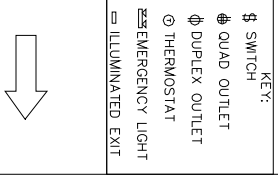

NORTH