

JENDOCO REAL ESTATE

TRY OUR
NEW WEBVISION

jendoco-re.com

Parkway West Business Park
517 Parkway View Drive
2,940 Total Square Feet
616 Square Feet of Finished Office



MAIN FEATURES

- Clear Height: 16ft. Above finished floor to underside of structural steel
- Exterior: Insulated wall panel
- Glass wall system at offices

UTILITIES

- Electric: 120/208 volt, three phase four wire
- Natural Gas: Equitable
- Water & Sewage: Robinson Twp.

MISCELLANEOUS

- Ample truck access and maneuvering
- Drive-in door at dock
- 24 hour, 7 day a week access



Contact Bob Lloyd - T 412-361-4509 F 412-361-4790 - Internet www.jendoco-re.com

All information furnished regarding properties for rent or sale are subject to errors, omissions, change of price or rental and change or withdraw without notice. Rental terms, all dimensions and specifications are approximate and subject to change without notice.

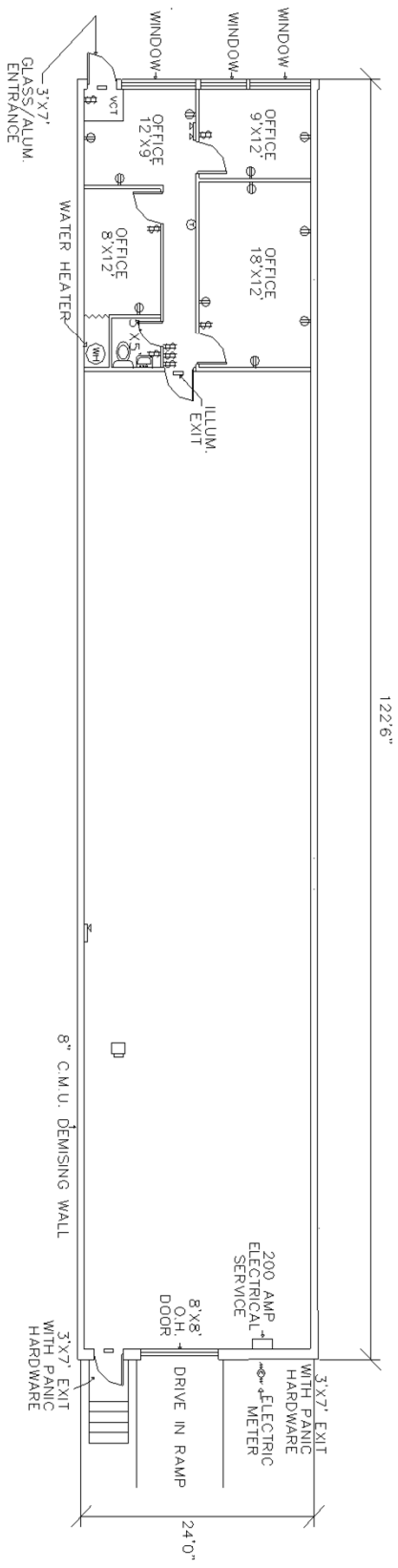

2940 SQUARE FEET TOTAL
616 SQUARE FEET FINISHED OFFICE

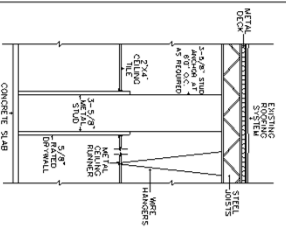

ALL INFORMATION ON THIS DRAWING MUST BE FIELD VERIFIED FOR ACCURACY. OWNER ASSUMES LIABILITY FOR INFORMATION UTILIZED FROM THIS DOCUMENT.

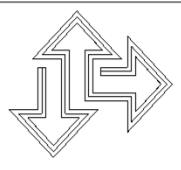

JENDOCO REAL ESTATE
CAD Design Team
 2000 Lincoln Road
 Pittsburgh, Pa 15235
 Phone: (412) 361 - 4509
 Fax: (412) 361 - 4790

PARKWAY WEST BUSINESS PARK	
SCALE: 1/8"=1'	APPROVED BY: SAMDOZ INC.
DATE: 9/30/93	REVISID 6/17/10
PW-517	
DRAWN BY: DET	REVISED

KEY:

- \$ SWITCH
- ⊕ QUAD OUTLET
- ⊕ DUPLEX OUTLET
- ⊙ THERMOSTAT
- ☒ EMERGENCY LIGHT
- ☐ ILLUMINATED EXIT

NORTH