

# JENDOCO REAL ESTATE

TRY OUR  
NEW WEBVISION

[jendoco-re.com](http://jendoco-re.com)

**Parkway West Business Park**  
**1815 Parkway View Drive**  
**14,183 Total Square Feet**  
**4,381 Square Feet of Finished Office**



#### MAIN FEATURES

- Clear Height: 16ft. Above finished floor to underside of structural steel
- Exterior: Insulated wall panel
- Glass wall system at offices

#### UTILITIES

- Electric: 120/208 volt, three phase four wire
- Natural Gas: Equitable
- Water & Sewage: Robinson Twp.

#### MISCELLANEOUS

- Ample truck access and maneuvering
- 4 ft. high loading docks
- 24 hour, 7 day a week access



Contact Bob Lloyd - T 412-361-4509 F 412-361-4790 - Internet [www.jendoco-re.com](http://www.jendoco-re.com)

All information furnished regarding properties for rent or sale are subject to errors, omissions, change of price or rental and change or withdraw without notice. Rental terms, all dimensions and specifications are approximate and subject to change without notice.

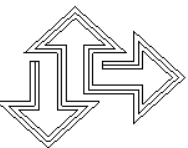

2000 Lincoln Road  
Pittsburgh, PA 15235

Phone: (412) 361 - 4509  
Fax: (412) 361 - 4790

# JENDOCO REAL ESTATE CAD Design Team

## PARKWAY WEST BUSINESS PARK

SCALE: 1/8"=1'	APPROVED BY: SANDOZ INC.	DRAWN BY: PB
DATE: 11/24/93	REVISSED 3/16/20	

PW-1815



NORTH

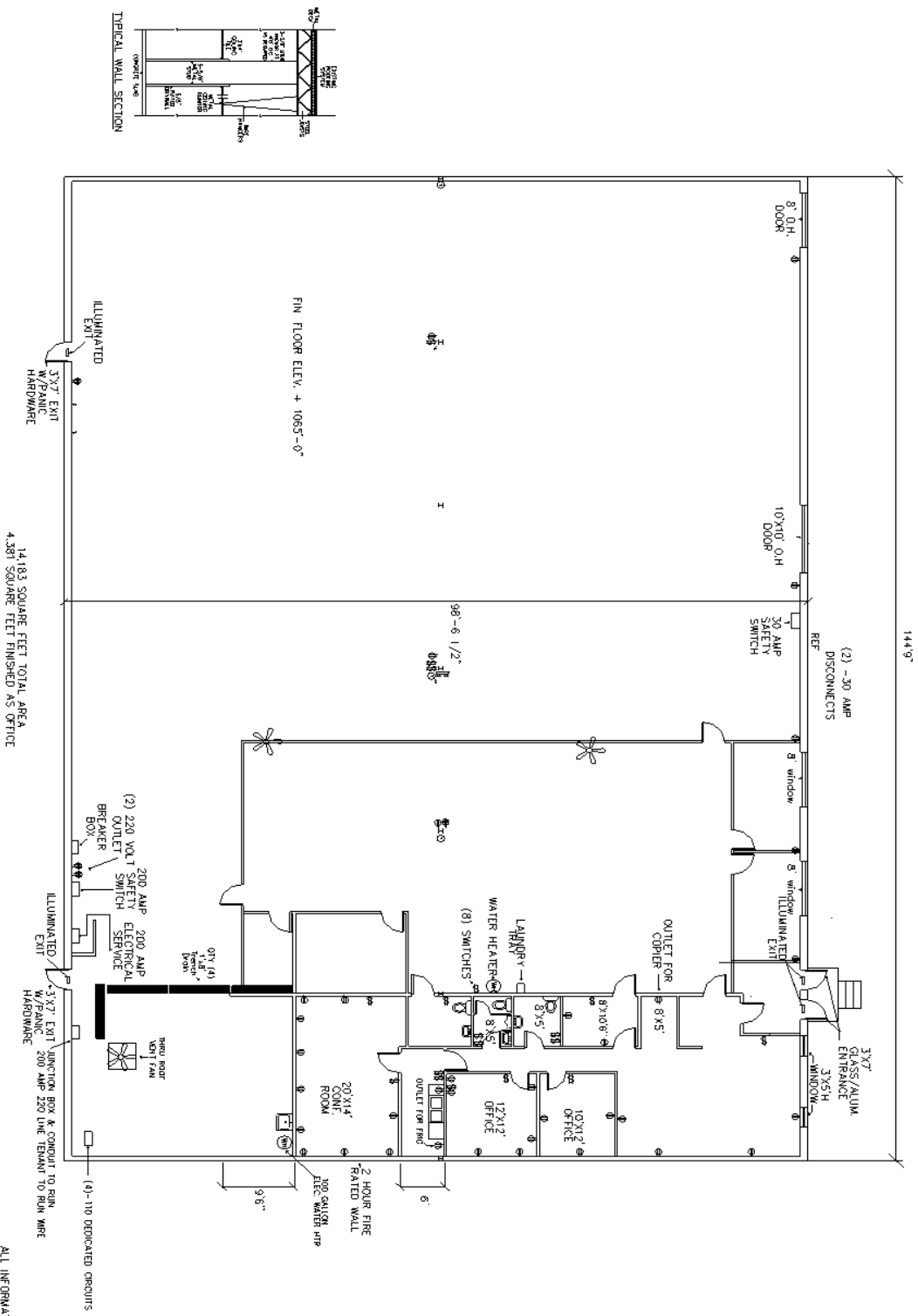

LEGEND	
	THRU ROOF VENT FAN
	CEILING FAN
	DUPLEX OUTLET
	QUAD OUTLET
	SWITCH
	THERMOSTAT
	EMERGENCY LIGHT
	AIR VALVE

ALL INFORMATION ON THIS DRAWING MUST BE FIELD VERIFIED FOR ACCURACY. OWNER ASSUMES THIS DOCUMENT.